

AK18 Series Elevator Push Buttons



Button Optional	Feature
1) Emergency light button and Buzzer button for over load 2) Connection:small terminal connection 3) Voltage:DV24V,DC12V for the Buzzer button,DC6V for the Emergency light button	1) Button surface material:outer frame material is ABS,button surface cover material is stainless steel and transparent PC 2) The thickness of installation plate:2-3mm 3) Installed by plastic clipping

Circuit Diagram:

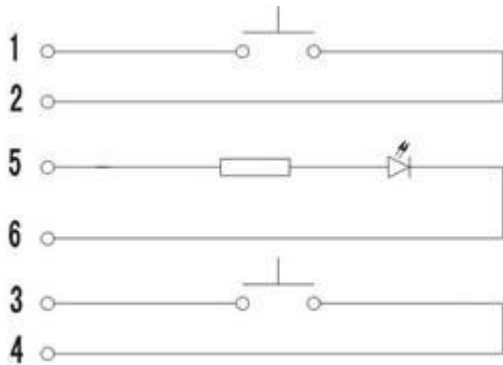
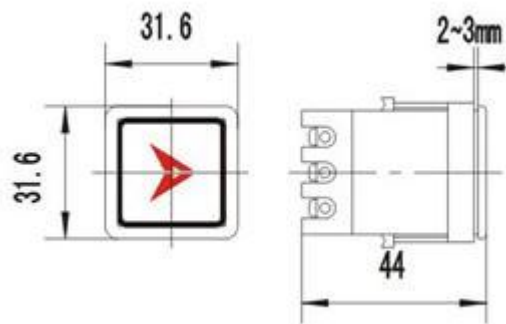
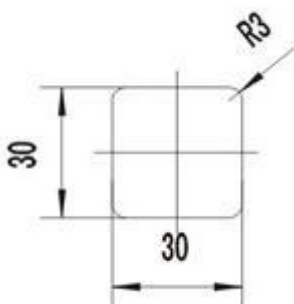

Figure Dimension:



Install Mounting Dimension:



Web:www.elevator-buttons.com

Email:sales@elevator-buttons.com